

PERMIT  
 CITY OF NAPOLEON, OHIO - BUILDING DEPARTMENT  
 255 West Riverview Avenue, Napoleon, Ohio 43545 - (419) 592-4010

Permit No. 3160 Issued 04/04/94

Job Location 4 Lakeview Dr.

Lot \_\_\_\_\_

Issued by Brent N. DAMMAN

Owner Hal Griffin 599-3538

Address 4 Lakeview Dr. 599-3538

Agent New Concepts 337-2323

Address 1028 Ottokee St. Wauseon, OH

Use Type - Residential X

Other - Describe \_\_\_\_\_

No. Dwelling Units \_\_\_\_\_

New Replacement

Add'n. X Alter \_\_\_\_\_ Remodel \_\_\_\_\_

Mixed Occupancy \_\_\_\_\_

Change of Occupancy \_\_\_\_\_

Estimated Cost \$ 7454.00

FEES	BASE	PLUS	TOTAL
<input checked="" type="checkbox"/> Building	\$ 9.00	\$ 42.00	\$ 51.00
<input type="checkbox"/> Electrical	\$	\$	\$
<input type="checkbox"/> Plumbing	\$	\$	\$
<input type="checkbox"/> Mechanical	\$	\$	\$
<input type="checkbox"/> Demolition	\$	\$	\$
<input type="checkbox"/> Zoning	\$	\$	\$
<input type="checkbox"/> Sign	\$	\$	\$
<input type="checkbox"/> Water Tap	\$	\$	\$
<input type="checkbox"/> Sew. Insp.	\$	\$	\$
<input type="checkbox"/> Sewer Tap	\$	\$	\$
<input type="checkbox"/> Temp. Water	\$	\$	\$
<input type="checkbox"/> Temp. Elec.	\$	\$	\$
TOTAL FEES.....			\$ 51.00
LESS FEES PAID.....			\$ 51.00
BALANCE DUE.....			\$ -0-

ZONING INFORMATION

district	lot dimensions		area	front yd	side yd	rear yd
max hgt	no pkg spaces	no ldg spaces	max cover	petition or appeal req'd		date appr

WORK INFORMATION

Size: Length \_\_\_\_\_ Width \_\_\_\_\_ Stories \_\_\_\_\_ Ground Floor Area \_\_\_\_\_

Height \_\_\_\_\_ Building Volume (for Demo. Permit) \_\_\_\_\_

Electrical: \_\_\_\_\_

Plumbing: \_\_\_\_\_

Mechanical: \_\_\_\_\_

**PAID**

APR 04 1994

CITY OF NAPOLEON

Additional Information: Will be enclosing wood duck with glass and extending roof over glass and will be preparing for a hot tub with new electric outlets.

Date 3/30/94 Applicant Signature Ruth K. Griffin

# INSPECTION RECORD

	UNDERGROUND			ROUGH-IN						FINAL		
	Type	Date	By	Type	Date	By	Type	Date	By	Type	Date	By
<b>PLUMBING</b>	Building Drains			Drainage, Waste & Vent Piping			Indirect Waste			Drainage, Waste & Vent Piping		
	Water Piping									Backflow Prevention		
	Building Sewer			Water Piping			Condensate Lines			Water Heater		
	Sewer Connection									FINAL APPROVAL		
<b>MECHANICAL</b>	Refrigerant Piping			Refrigerant Piping			Chimney(s)			Grease Exhaust System		
				Duct Furnace(s)			Fire Dampers			Air Cond. Unit(s)		
	Ducts/ Plenums			Ducts/ Plenums			<input type="checkbox"/> Radiant Htr(s) <input type="checkbox"/> Unit Htr(s)			Refrigeration Equipment		
				Duct Insulation			Pool Heater			Furnace(s)		
				Combustion Products Vents			Ventilation <input type="checkbox"/> Supply <input type="checkbox"/> Exhst.			FINAL APPROVAL		
<b>ELECTRICAL</b>	Conduits & or Cable			Conduits/ Cable			<input type="checkbox"/> Range <input type="checkbox"/> Dryer			Temp Service Temp Lighting		
	Grounding & or Bonding			Rough Wiring			<input type="checkbox"/> Generator(s) <input type="checkbox"/> Motors			Fixtures Lampholders		
	Floor Ducts Raceways			Service Panel Switchboard			<input type="checkbox"/> Water Htr <input type="checkbox"/> Welder			Signs		
	Service Conduit			Busways Ducts			<input type="checkbox"/> Heaters <input type="checkbox"/> Heat Cable			Electric Mtr. Clearance		
	Temporary Power Pole			Subpanels			<input type="checkbox"/> Duct Htr(s) <input type="checkbox"/> Furnace(s)			FINAL APPROVAL	5/6	BD
<b>BUILDING</b>	Location, Set-backs, Esmt(s)			Exterior Wall Construction			Roof Covering Roof Drainage	5/6	BD	Smoke Detector		
	Excavation						Exterior Lath	5/6	BD	Demolition (sewer cap)		
	Footings & Reinforcing						<input type="checkbox"/> Interior Lath <input type="checkbox"/> Wallboard					
	Floor Slab			Interior Wall Construction			Fire Wall(s)			Building or Structure		
	Foundation Walls			Columns & Supports			Fireplace Chimney					
	Sub-soil Drain			Crawl Space <input type="checkbox"/> Vent <input type="checkbox"/> Access			Attic <input type="checkbox"/> Vent <input type="checkbox"/> Access					
	Piles			Floor System(s)	5/6	BD				FINAL APPROVAL BLDG. DEPT.	5/10	BD
				Roof System	5/6	BD	Special Insp Reports Rec'd			Certificate of Occupancy Issued		
<b>ADDITIONAL</b>	INSPECTIONS, CORRECTIONS, ETC.						INSPECTIONS, CORRECTIONS, ETC.					

**APPLICATION FOR**

Residential, Building, Electrical, Plumbing, Mechanical, and Demolition Permit

FROM - The City of Napoleon, Ohio, Building Department

255 West Riverview Avenue; P.O. Box 151; Napoleon, Ohio 43545 - Telephone (419) 592-4010

ENTRY NO. \_\_\_\_\_

PERMIT NO. 3160 ISSUED 4-4-94

JOB LOCATION 4 Lakeview Dr

LOT \_\_\_\_\_  
(Subdivision or Legal Description)

ISSUED BY Roger O Freytag  
(Building Official)

OWNER Hal Griffin PHONE 599 3538

ADDRESS 4 Lakeview Dr

AGENT New Concepts PHONE 337-2323

ADDRESS 1028 Ottokee St. Wauseon, Ohio

USE:  Residential ( ) Commercial ( ) Industrial 43567  
( ) Other \_\_\_\_\_

WORK: ( ) New  Addition ( ) Replacement ( ) Remodel

ESTIMATED COST = \$ 757.00

	<u>Base</u>	<u>Plus</u>	<u>Total</u>
<input checked="" type="checkbox"/> Building	\$ <u>9.00</u>	\$ <u>42.00</u>	\$ <u>51.00</u>
( ) Electrical	\$ _____	\$ _____	\$ _____
( ) Plumbing	\$ _____	\$ _____	\$ _____
( ) Mechanical	\$ _____	\$ _____	\$ _____
( ) Demolition	\$ _____	\$ _____	\$ _____
( ) Zoning	\$ _____	\$ _____	\$ _____
( ) Sign	\$ _____	\$ _____	\$ _____
( ) Water Tap	\$ _____	\$ _____	\$ _____
( ) Sewer Tap	\$ _____	\$ _____	\$ _____
( ) Temp Water	\$ _____	\$ _____	\$ _____
( ) Temp Elec.	\$ _____	\$ _____	\$ _____

Additional Plan Review: Structure \_\_\_\_\_ Hours \_\_\_\_\_  
Electric \_\_\_\_\_ Hours \_\_\_\_\_

TOTAL FEES . . . . .	\$ <u>51.00</u>
Less Fees Paid . . . . .	\$ _____
BALANCE DUE . . . . .	\$ <u>51.00</u>

ZONING INFORMATION

<u>District</u>	<u>Lot Dimensions</u>	<u>Area</u>	<u>Front Yard</u>	<u>Side Yard</u>	<u>Rear Yard</u>

<u>Max Height</u>	<u>No. Pkg. Spaces</u>	<u>No. Ldg. Spaces</u>	<u>Max Cover</u>	<u>Petition or Appeal Required-Date</u>

WORK INFORMATION

Building: Ground Floor Area \_\_\_\_\_ sq. ft. Basement Floor Area \_\_\_\_\_ sq. ft.  
 Garage Floor Area \_\_\_\_\_ sq. ft. 2nd Floor Area \_\_\_\_\_ sq. ft. Other \_\_\_\_\_ sq. ft.  
 Size: Width \_\_\_\_\_ Length \_\_\_\_\_ Stories \_\_\_\_\_ Height \_\_\_\_\_  
 Building Volume (for Demolition Permit) \_\_\_\_\_ cubic feet

**PAID**  
APR 04 1994  
CITY OF NAPOLEON

Description of Work: Will be enclosing wood deck with glass and extending roof over glass and will be preparing for a hot tub with new electric outlets



ELECTRICAL: Contractor \_\_\_\_\_ Phone \_\_\_\_\_

Address \_\_\_\_\_ ESTIMATED COST = \$ \_\_\_\_\_

Type of Work: ( ) New ( ) Service Change ( ) Rewiring ( ) Add'l Wiring TEMPORARY ELEC. REQUIRED - ( ) Yes ( ) No

Size of Service \_\_\_\_\_ Underground \_\_\_\_\_ Overhead \_\_\_\_\_ Number of New Circuits \_\_\_\_\_

Description of Work: \_\_\_\_\_

PLUMBING: Contractor \_\_\_\_\_ Phone \_\_\_\_\_

Address \_\_\_\_\_ ESTIMATED COST = \$ \_\_\_\_\_

WATER TAP REQUIRED - ( ) Yes ( ) No Size \_\_\_\_\_ Type of Pipe \_\_\_\_\_ Water Dist. Pipe \_\_\_\_\_

SANITARY SEWER TAP REQUIRED - ( ) Yes ( ) No Size \_\_\_\_\_ Type of Pipe \_\_\_\_\_ Dr. Waste Vt. Pipe \_\_\_\_\_

STREET SEWER TAP REQUIRED - ( ) Yes ( ) No Type of Pipe \_\_\_\_\_ STREET TO BE OPENED - ( ) Yes ( ) No

Main Building Drain Size = \_\_\_\_\_ Main Vent Pipe Size = \_\_\_\_\_

LIST NUMBER OF PLUMBING FIXTURES BELOW:

Water Closets = \_\_\_\_\_ Bathtubs = \_\_\_\_\_ Showers = \_\_\_\_\_ Lavatories = \_\_\_\_\_ Kitchen Sinks = \_\_\_\_\_ Disposal = \_\_\_\_\_

Clothes Washer = \_\_\_\_\_ Floor Drains = \_\_\_\_\_ Dishwasher = \_\_\_\_\_ Other \_\_\_\_\_ Total = \_\_\_\_\_

Description of Work: \_\_\_\_\_

MECHANICAL: Contractor \_\_\_\_\_ Phone \_\_\_\_\_

Address \_\_\_\_\_ ESTIMATED COST = \$ \_\_\_\_\_

HEATING SYSTEM - ( ) Forced Air ( ) Gravity ( ) Hot Water ( ) Steam ( ) Unit Heaters ( ) Radiant ( ) Baseboard

TYPE OF FUEL - ( ) Electric ( ) Natural Gas ( ) Propane ( ) Wood ( ) Coal ( ) Solar ( ) Geothermal Other \_\_\_\_\_

NUMBER OF HEAT ZONES = \_\_\_\_\_ HOT WATER - ( ) One (1) Pipe ( ) Two (2) Pipes ( ) Series Loop

ELECTRIC HEAT - Number of Circuits \_\_\_\_\_ Number of Furnaces \_\_\_\_\_ Number of Hot Air Runs \_\_\_\_\_

Number of Hot Water Radiators \_\_\_\_\_ Total Heat Loss \_\_\_\_\_ Rated Capacity of Furnace/Boiler \_\_\_\_\_

LOCATION OF HEATING UNITS - ( ) Crawl Space ( ) Floor Level ( ) Attic ( ) Suspended ( ) Roof ( ) Outside

Description of Work: \_\_\_\_\_

DRAWINGS REQUIRED: All applications must be accompanied by two (2) complete sets of Drawings including Site Plans, Foundation Plans, Floor Plans, Structural Framing Plans, Exterior Elevations, Section and Details, Stair Details, Electrical Layout, Plumbing Isometric, Heating Layout, etc. All Plans shall be drawn to scale, show all existing structure on the Site Plans, and show electric panel and furnace locations.

READ AND SIGN BELOW: The undersigned hereby makes application for a Permit for all work described herein and agrees to complete the work in strict accordance with all applicable provisions of the current edition of the C.A.B.O. Building Code, the Napoleon Building and Zoning Codes, the Napoleon Engineering Department Rules and Regulations, Standard Specifications and other pertinent sections of the Napoleon Code of Ordinances.

Signature of Applicant Ruth K. Griffin Date 3/30/94

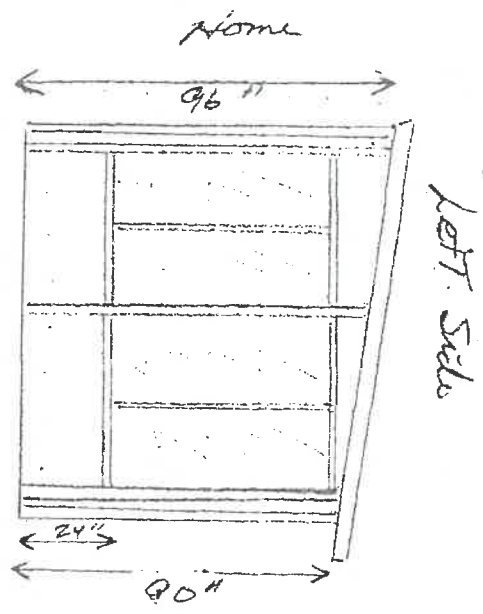
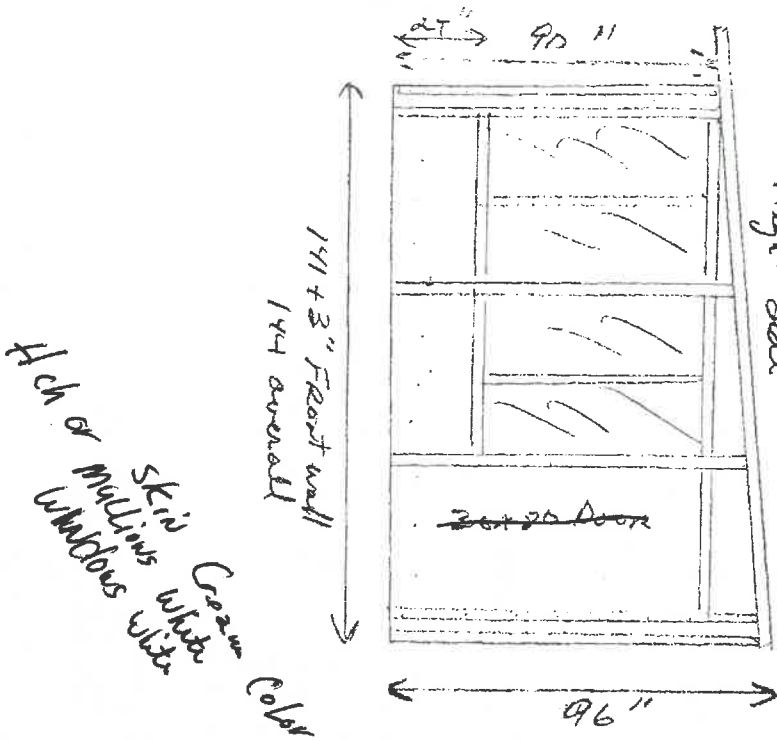

Mr & Mrs  
Griffin

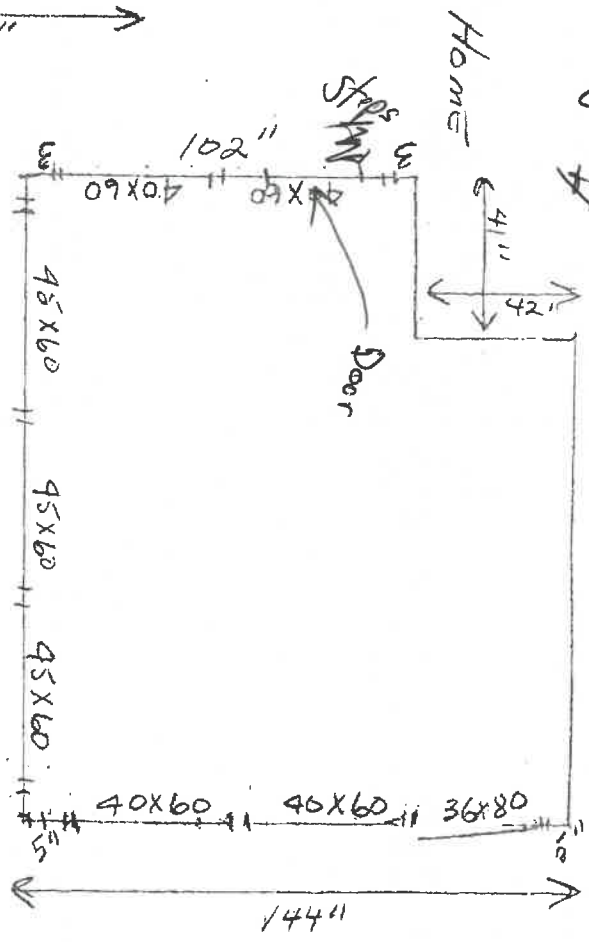
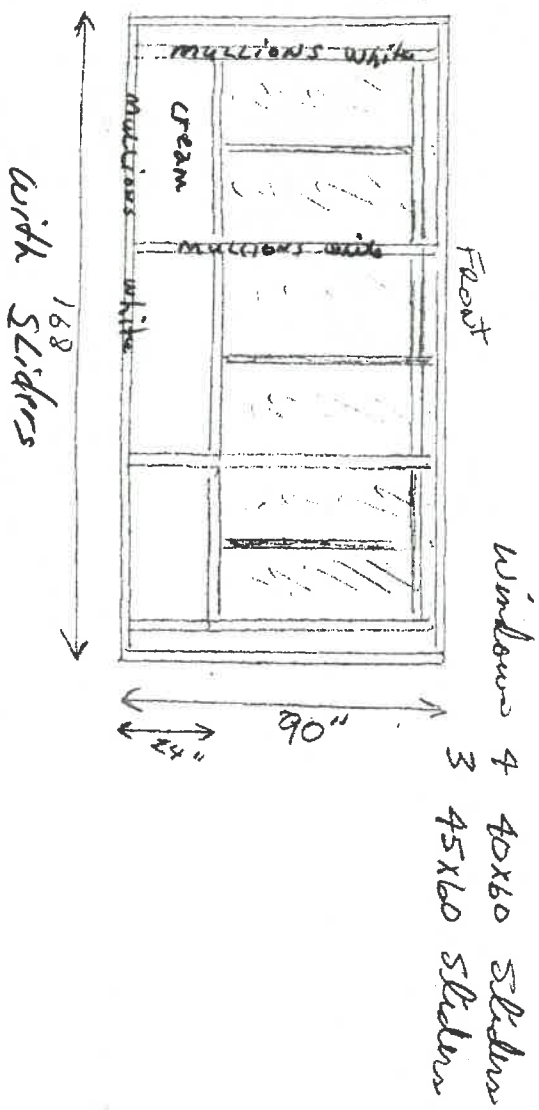

OK by Spm Edwards  
New Concept in Sliding  
Owner  
Ruth Griffin

A Lakeview Dr



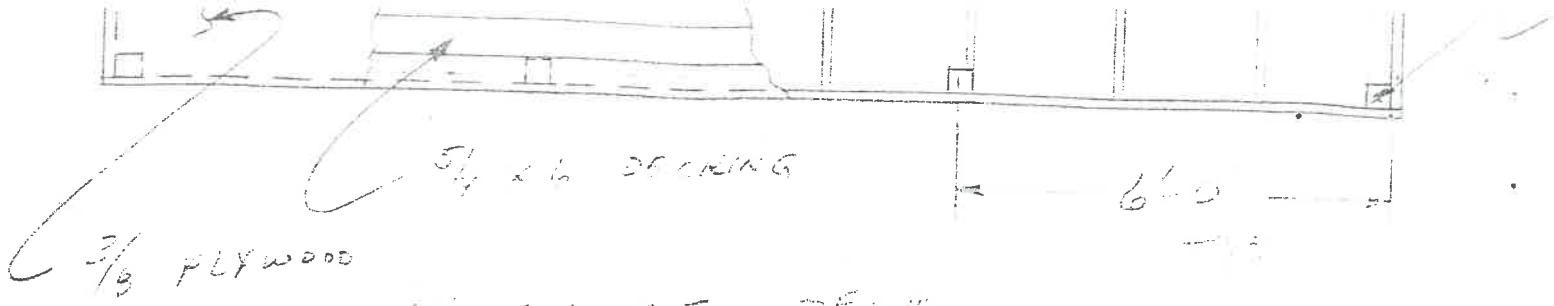

5/4 x 6 DECKING

6'-0"

3/8 PLYWOOD

VIEW OF DECK  
W/O BUILDING

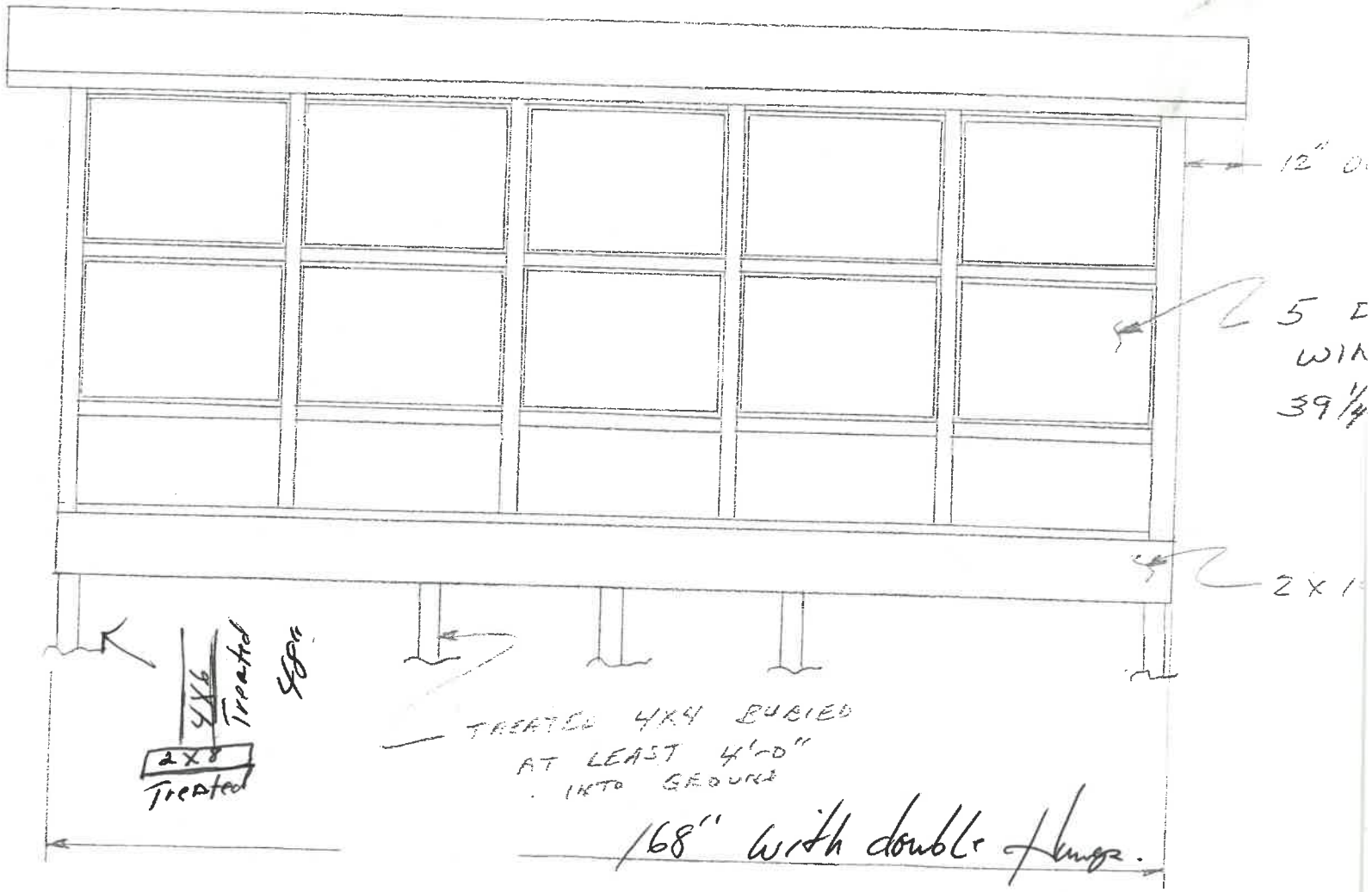

12" O

5 I  
WIN  
39 1/4

2 x 1

4x6  
Treated  
48"  
2x8  
Treated

TREATED 4x4 BURIED  
AT LEAST 4'-0"  
INTO GROUND

168" with double hinges.

NORTH SIDE





## "INSULATED" ENCLOSURE FLOORING

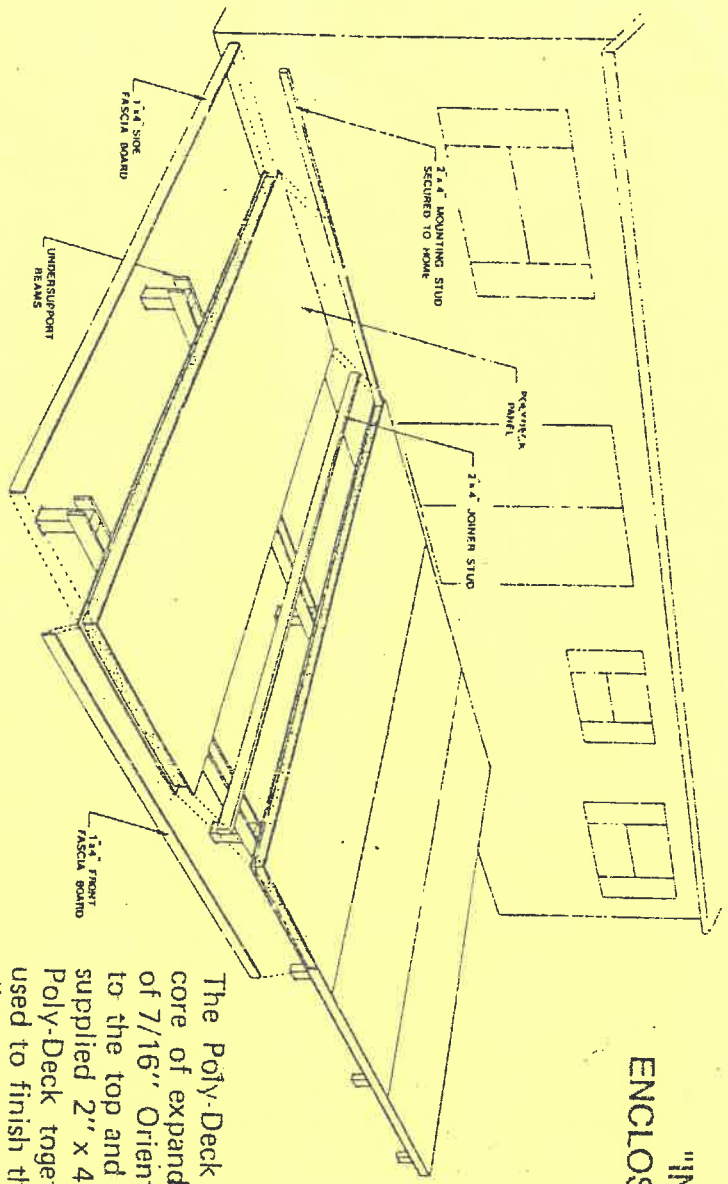

The Poly-Deck panels consist of a 3-5/8" core of expanded polystyrene with sheets of 7/16" Oriented Strand Board laminated to the top and bottom of the core. Dealer supplied 2" x 4" studs are used to join the Poly-Deck together and 1" x 4" studs are used to finish the outside edges of the paneling system. Simple, logical, economical...

**Adrian Office:** 9500 Fortister Rd., Adrian, MI 49221  
 (517) 263-6403  
 (517) 263-2617 (Fax)

**Wauseon Office:** 1028 Ottokee St., Wauseon, OH 43567  
 (419) 337-2323  
 (419) 337-3976 (Fax)

**Alcoa • Alside • Pella • Nue-Vue 2000**  
*We deal direct with manufacturers*  
 3 Generation Family Owned Business  
 Since 1950

Richard Bayes - Sales



- Courtesy Car Service
- 100% Vinyl Siding
  - Vinyl Cedar Shakes
  - Patio Enclosures
  - Screen Houses
  - Steel Wood Grain Doors
  - Patio Doors
  - Insulated Roof Over
  - Storm Doors
  - Vinyl Replacement Windows
  - Bay & Bows
  - Decks
  - Hot Tubs
  - Vinyl Storm Windows





65 Quick Road • New Carlisle, Ohio 45344 • (513) 845-9404 • FAX 845-9424

### LAMINATED PANEL FIRE CODE REQUIREMENTS

Laminated panels using 7/16" Oriented Strand Board meet the BOCA requirements for fire codes:

According to BOCA CODE:

2002.3.4 Roofing: Foam plastic used in a roof covering assembly without the thermal barrier shall have the foam separated from the interior of the building by plywood sheathing that is not less than 15/32 inch in thickness bonded with exterior glue, with the edges supported by blocking, tongue-and-groove joints or other approved types of edge support, or an equivalent material. For all roof applications, the smoke developed rating shall not be applicable.



August 28, 1990

To Whom It May Concern

RE: Patio/Room Cover Panels

The report on your 10, 11, and 12 feet span laminated .024 aluminum skins both sides over rigid polystyrene core panels is complete. The analysis and recommendations are based upon experimental load testing results as performed by your forces. Test procedures conform to the method described by the American Society for Testing and Materials, Section E-72, "Conducting Strength Tests of Panels for Building Constructing". Please refer to the report for details of the test equipment and method, panel construction material specifications, results of the load testing, and engineering analysis.

We recommend the following panel ratings:

LOAD FACTOR

w = Maximum allowable superimposed live load in pounds per square foot with a Factor of Safety = 2.5

<u>Span</u>	<u>w</u>
10'	58 psf
11'	48 psf
12'	40 psf

WORKING LOAD DEFLECTION

d = Allowable working load deflection (L/180)  
p = Maximum allowable working load in pounds per square foot

<u>Span</u>	<u>d</u>	<u>p</u>
10'	0.67"	45 psf
11'	0.73"	38 psf
12'	0.80"	31 psf



Prepared:

Brian Thebeault  
Project Engineer

Reviewed:

*Brian Thebeault*

Edward Brown  
Professional Engineer

*Edward J. Brown*







BASED ON THE TEST IN ACCORDANCE WITH ASTM E-72, THE FOLLOWING RESULTS WERE OBTAINED.

THE DESIGN LOAT INCORPORATES THE 2.5 SAFETY FACTOR REQUIRED BY BOCA.

SPAN	DESIGN LOAD	ULTIMATE LOAD
10'	64	160
11'	56	141
12'	49	123
13'	42	106
14'	35	87
15'	28	70

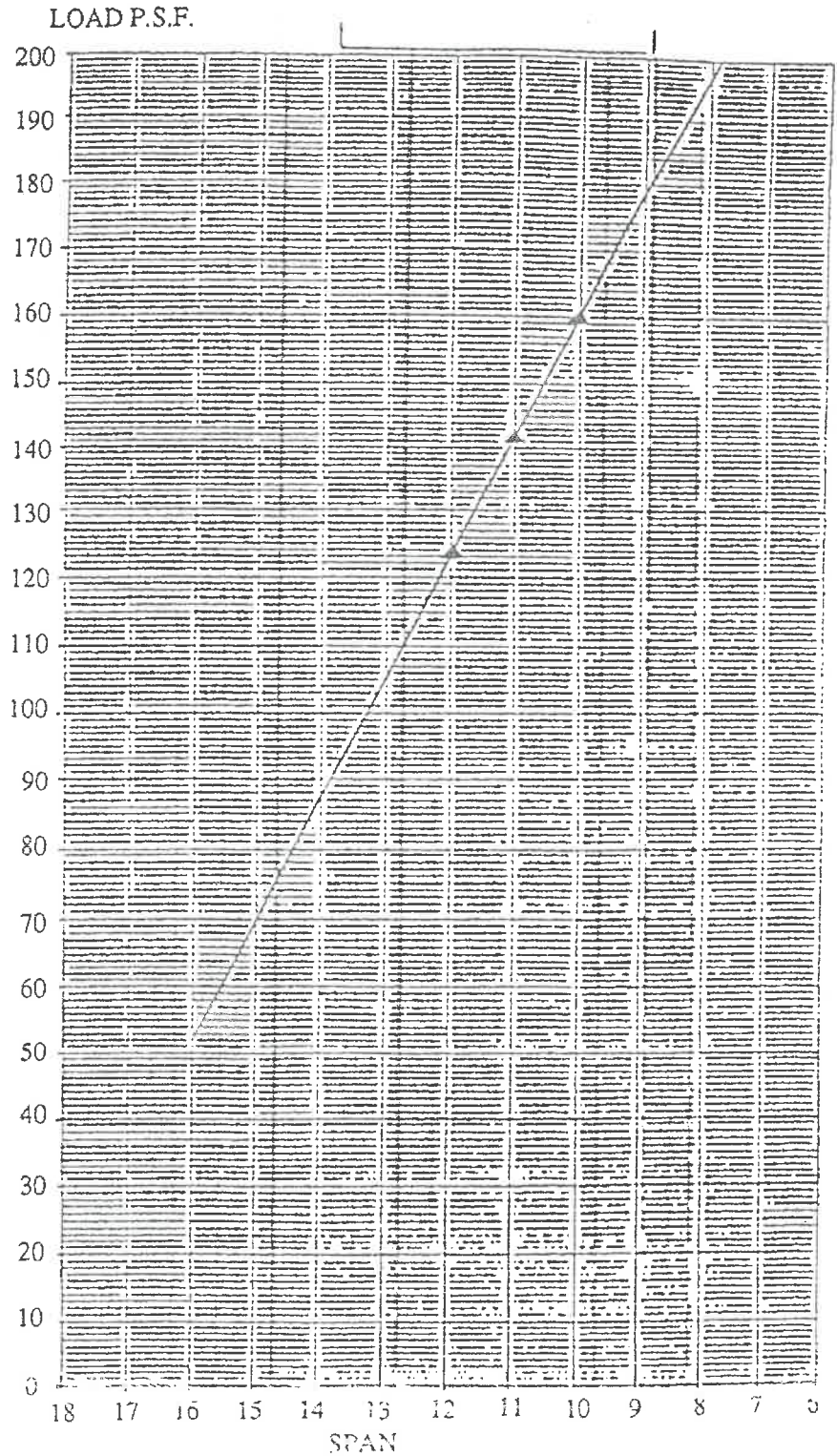



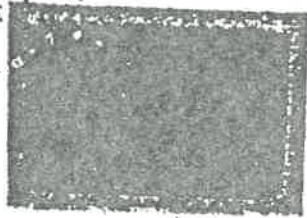

December 12, 1990

To Whom It May Concern:

RE: Patio/Room Wall Panels

The analysis and recommendations are based upon experimental load testing results. Test procedures conform to the method described by the American Society for Testing and Materials, Section E-72-80 "Conducting Strength Tests of Panels for Building Constructing". Please refer to the report for details of the test equipment and panel construction material specifications.

<u>AXIAL COMPRESSIVE LOAD</u>	<u>TYPE OF WALL ASSEMBLY</u>	
Wall Height	Solid accent 8'	Frame (doors/wnd) 8'
Allowable Wall Load (2.5 safety factor)	1205 lbs/ft	1010 lbs/ft
<u>RACKING LOAD</u>		
Allowable Axial Wall (2.5 safety factor)	79 lbs/ft	71 lbs/ft

Prepared:

Brian Thebeault  
Project Engineer

Reviewed:

Edward Brown  
Professional Engineer

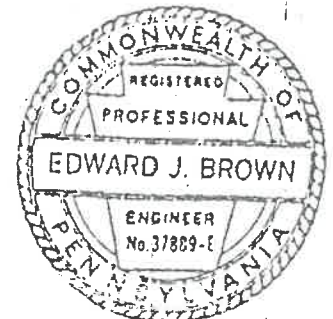





October 1, 1990

To Whom It May Concern:

RE: Patio/Room Cover Panels

The report on your Snaplock 10, 12, and 14 feet span laminated .024 aluminum skins both sides over rigid polystyrene core panels is completed. The analysis and recommendations are based upon experimental load testing results as performed by your forces. Test procedures conform to the method described by the American Society for Testing and Materials, Section E-72, "Conducting Strength Tests of Panels for Building Constructing". Please refer to the report for details of the test equipment and method, panel construction material specifications, results of the load testing, and engineering analysis.

We recommend the following panel ratings:

LOAD FACTOR

W = Maximum allowable superimposed live load  
in pounds per square foot with a Factor of  
Safety = 2.5

<u>Span</u>	<u>W</u>
10'	25.5 psf
12'	18 psf
14'	14 psf

Prepared:

Brian Thebeault  
Project Engineer

Reviewed:

Edward Brown  
Professional Engineer

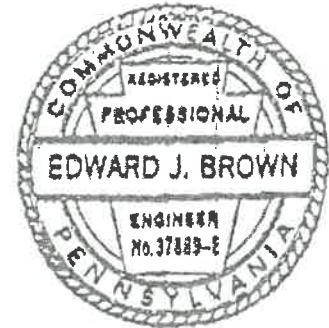

*Edward J. Brown*



### TYPICAL PANEL

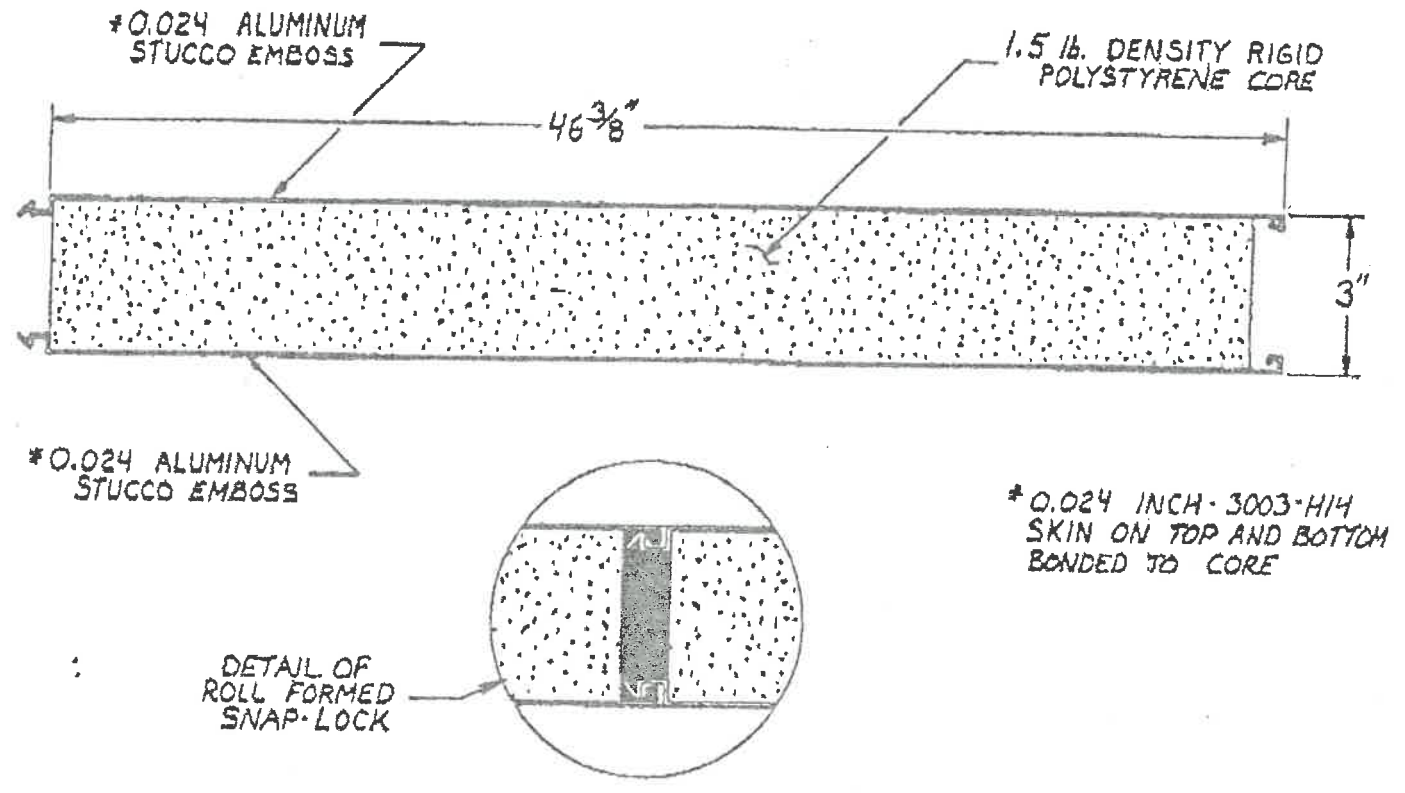



FAILURE POINT

LOAD P.S.F.

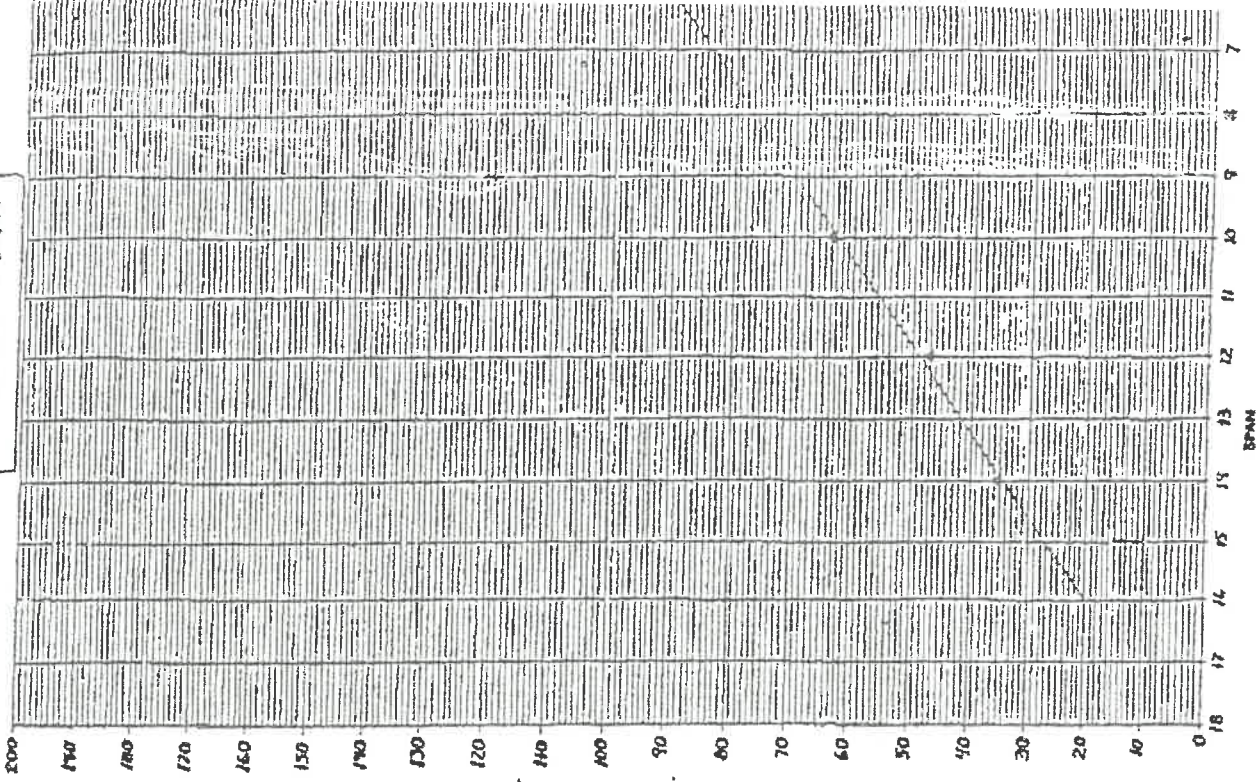

SNAP LOCK - EPS

Based on the test in accordance with ASTM E-72, the following results were obtained.

The design load incorporates the 2.5 safety factor required by BOCA.

Span	Design Load	Ultimate Load
10'	26	64
11'	22	56
12'	18.4	46
13'	17	42
14'	14	36
15'	11	27



